

### EXPLODED PARTS VIEW

LIGHT SPECIAL GRAPHITE CONSTRUCTION  
**FX 200**

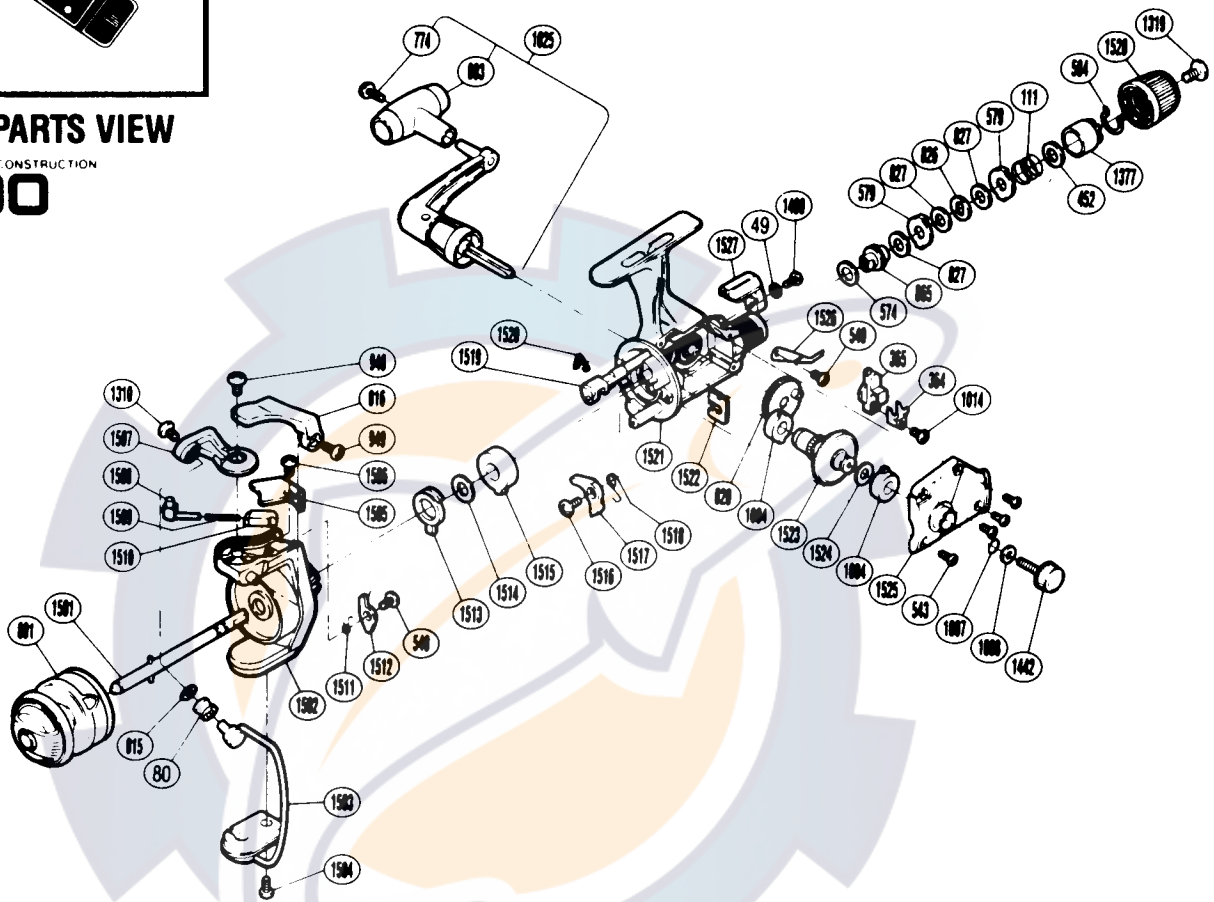

### PARTS LIST

**PART # DESCRIPTION**

- RD 0049 Lock Washer
- RD 0080 Line Roller
- RD 0111 Drag (Coil) Spring
- RD 0364 Oscillating Slider Retainer
- RD 0365 Oscillating Slider
- RD 0452 Drag Spring Washer "A"
- RD 0540 Anti-Reverse Pawl Screw
- RD 0543 Side Cover Screw (B)
- RD 0574 Drag Washer "C2" (White)
- RD 0579 Eared Washer "B"
- RD 0584 Hold Click Spring
- RD 0774 Handle Knob Screw
- RD 0801 Spool Assembly (Universal)
- RD 0803 Handle Knob
- RD 0815 Line Roller Washer
- RD 0816 Quick-Fire II Trigger
- RD 0820 Oscillating Gear
- RD 0826 Key Washer "A"
- RD 0827 Drag Washer "H1"
- RD 0865 Drag Shaft

**PART # DESCRIPTION**

- RD 0940 Bail Trip Cam Screw
- RD 0949 Trigger Screw
- RD 1004 Bushing A
- RD 1007 Lock Washer Retainer
- RD 1008 Handle Lock Washer
- RD 1014 Slider Retainer Screw
- RD 1025 Handle Assembly
- RD 1310 Line Roller Screw
- RD 1319 Drag Knob Screw
- RD 1377 Pressure Screw
- RD 1442 Handle Screw Cap
- RD 1490 Anti-Reverse Lever Screw
- RD 1501 Main Shaft
- RD 1502 Rotor
- RD 1503 Bail Assembly
- RD 1504 Bail Hold Cover Screw
- RD 1505 Bail Spring Cover
- RD 1506 Bail Spring Cover Screw
- RD 1507 Bail Arm
- RD 1508 Bail Spring Guide A

**PART # DESCRIPTION**

- RD 1509 Bail Spring
- RD 1510 Bail Spring Guide B
- RD 1511 Lever Spring
- RD 1512 Bail Trip Lever
- RD 1513 Anti-Reverse Lock Out
- RD 1514 Bushing Washer
- RD 1515 Bushing
- RD 1516 Anti-Reverse Pawl Screw
- RD 1517 Anti-Reverse Pawl
- RD 1518 Anti-Reverse Pawl Spring
- RD 1519 Anti-Reverse Cam
- RD 1520 Anti-Reverse Cam Spring
- RD 1521 Body
- RD 1522 Rotor Lock
- RD 1523 Drive Gear
- RD 1524 Drive Gear Washer
- RD 1525 Side Cover
- RD 1526 Drag Click
- RD 1527 Anti-Reverse Lever
- RD 1528 Drag Knob